

ITEM	SYM	PART NUMBER	QTY	DESCRIPTION
1		FLW06SS	3	FLATWASHER #6
2		FLW10SS	3	FLATWASHER #10
3		HN1032SS	6	HEX NUT #10-32
4		LASER_CAR_PLATE	1	LASER CAR PLATE
5		LENS_MNT	1	LEN/MIRROR ASSEMBLY
6		NOZZLE	1	ASSIST AIR NOZZLE
7		PHOTO_INT_PLATE	2	PHOTO INTERRUPTOR PLATE
8		PIPE_BARB_FITTING	1	1/8 BARBED PIPE FITTING
9		SHMS063208S	3	SOCKET HEAD SCREW #6-32 X 1/2
10		SHMS063212S	1	SOCKET HEAD SCREW #6-32 X 1/2
11		SHMS103216	3	SHMS #10-32 x 1.00
12		SLW06SS	3	SPLIT LOCK WASHER #6
13		SLW10SS	6	LOCKWASHER, SPLIT #10
14		SN0632SS	1	SQUARE NUT #6-32
15		V WHEEL	3	V WHEEL 3/16 SEALED

REVISIONS			
SYM	DESCRIPTION	BY	DATE
1	ORIGINAL	BJD	9/9/09
2	REVISED	BJD	2/18/10
3	Cleanup and added note.	BJD	2/20/10
4	Revised with new clamp and len configuration	BJD	5/2/10
5	Fixed hardware	BJD	6/6/10
6	Update wheel tensioner and clamping method	BJD	10/19/10

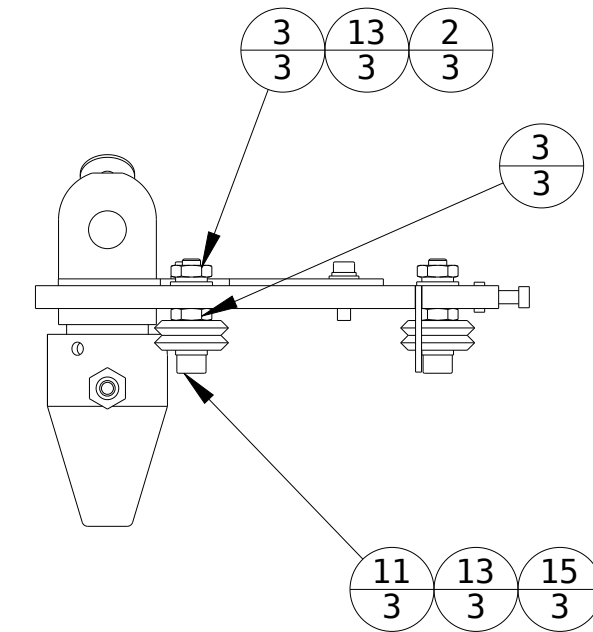

Attach these items to v wheels first, then attach to plate.

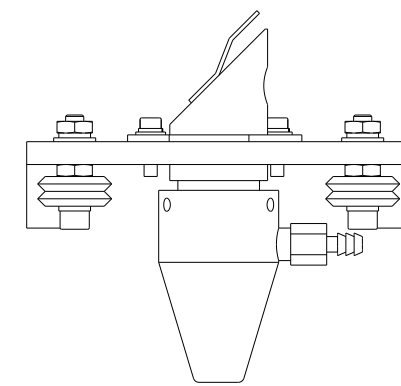
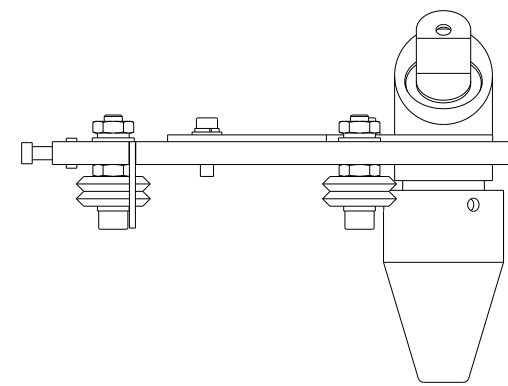
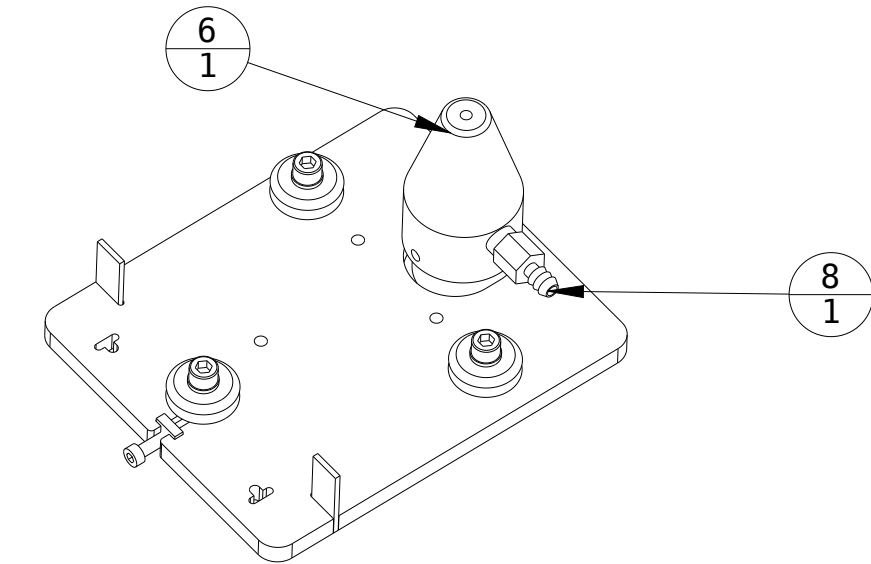
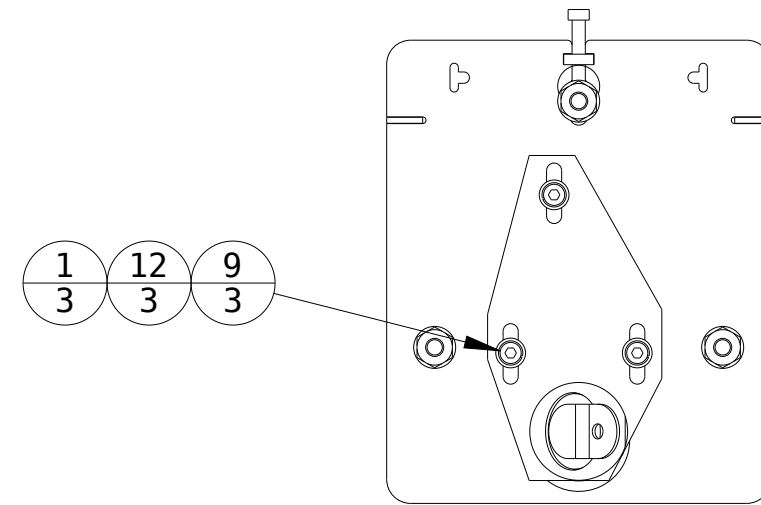
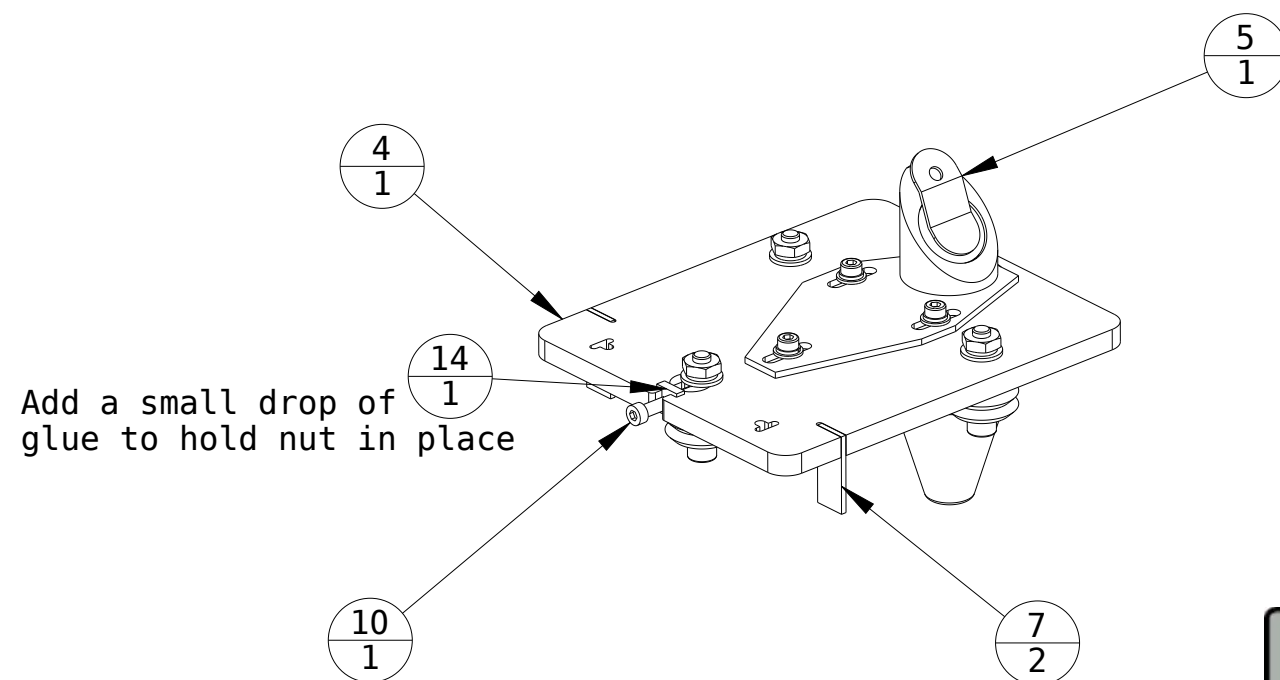

Notes:

- Holes in V-wheels are .187 dia. and the #10-32 screws are .189 dia. so they need to be sanded down slightly. I put the head in a drill chuck and spun them on some sand paper or a flat file for a few seconds each.

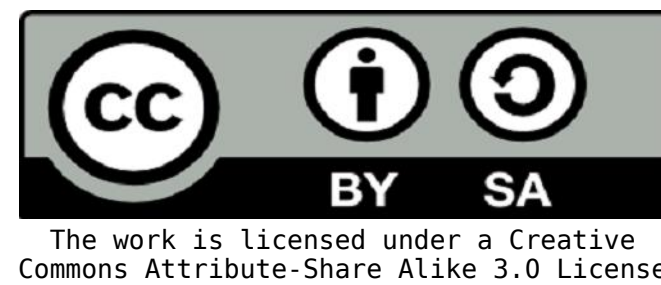

UNLESS OTHERWISE SPECIFIED:	DRAWN	BJD	9/9/09
FRACTIONAL ± 1/32	CHECKER		
DECIMAL .XXX ± .010	MECH. ENGR.		
.XX ± .020	ELEC. ENGR.		
ANGULAR ± 1/2°	PROJ. ENGR.		
MATERIAL SPEC:	CHIEF ENGR.		
FINISH SPEC:			

LASER CAR ASSEMBLY		www.buildlog.net
SCALE		SHEET 1 OF 1