

1

2

3

4

5

6

REVISIONS			
SYM	DESCRIPTION	BY	DATE
1	ORIGINAL	BJD	12/16/10
2	Updated Design	BJD	1/13/11
3	Added missing dims	BJD	1/25/11
4	Added 0.438 Hole	BJD	2/23/11
5	Moved lower wheel hole	BJD	10/18/11

D

C

B

A

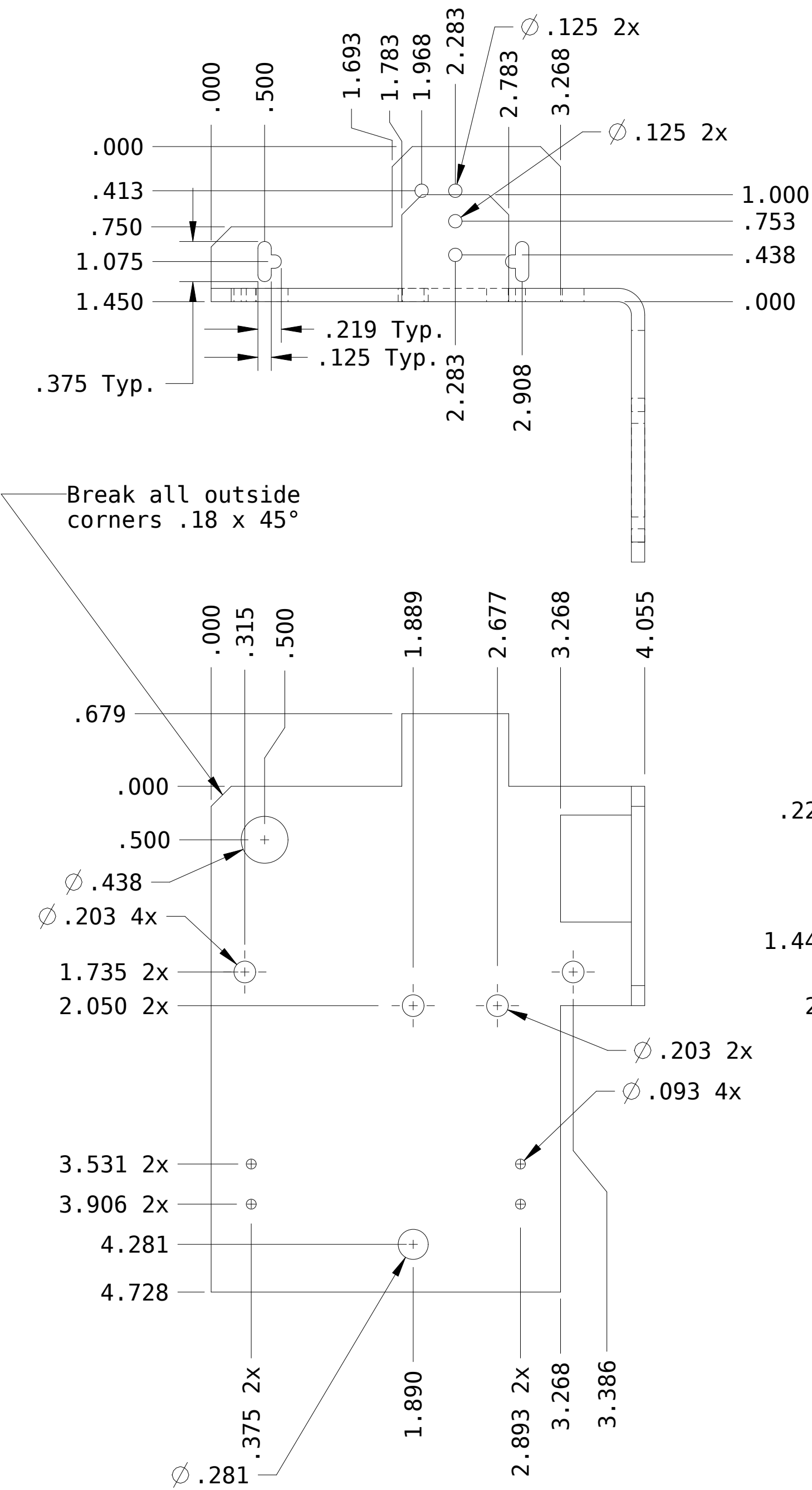

Break all outside corners .18 x 45°

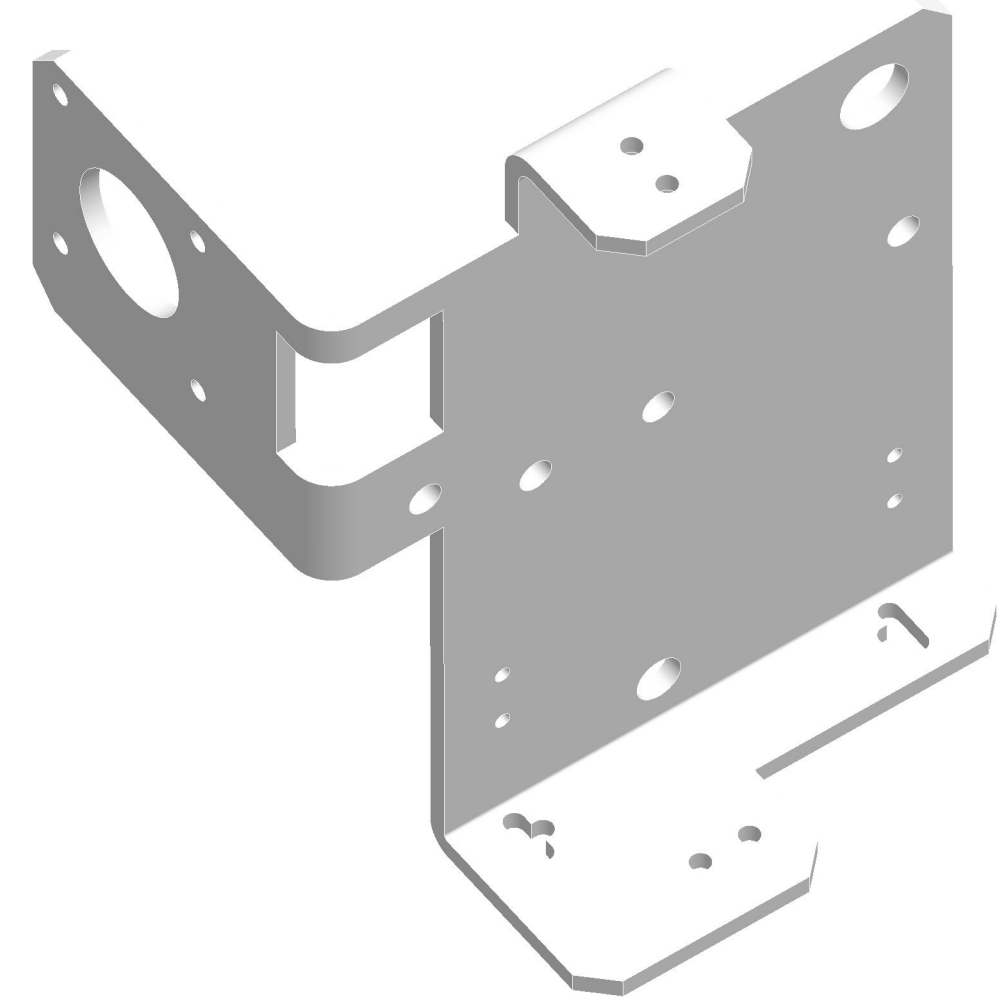
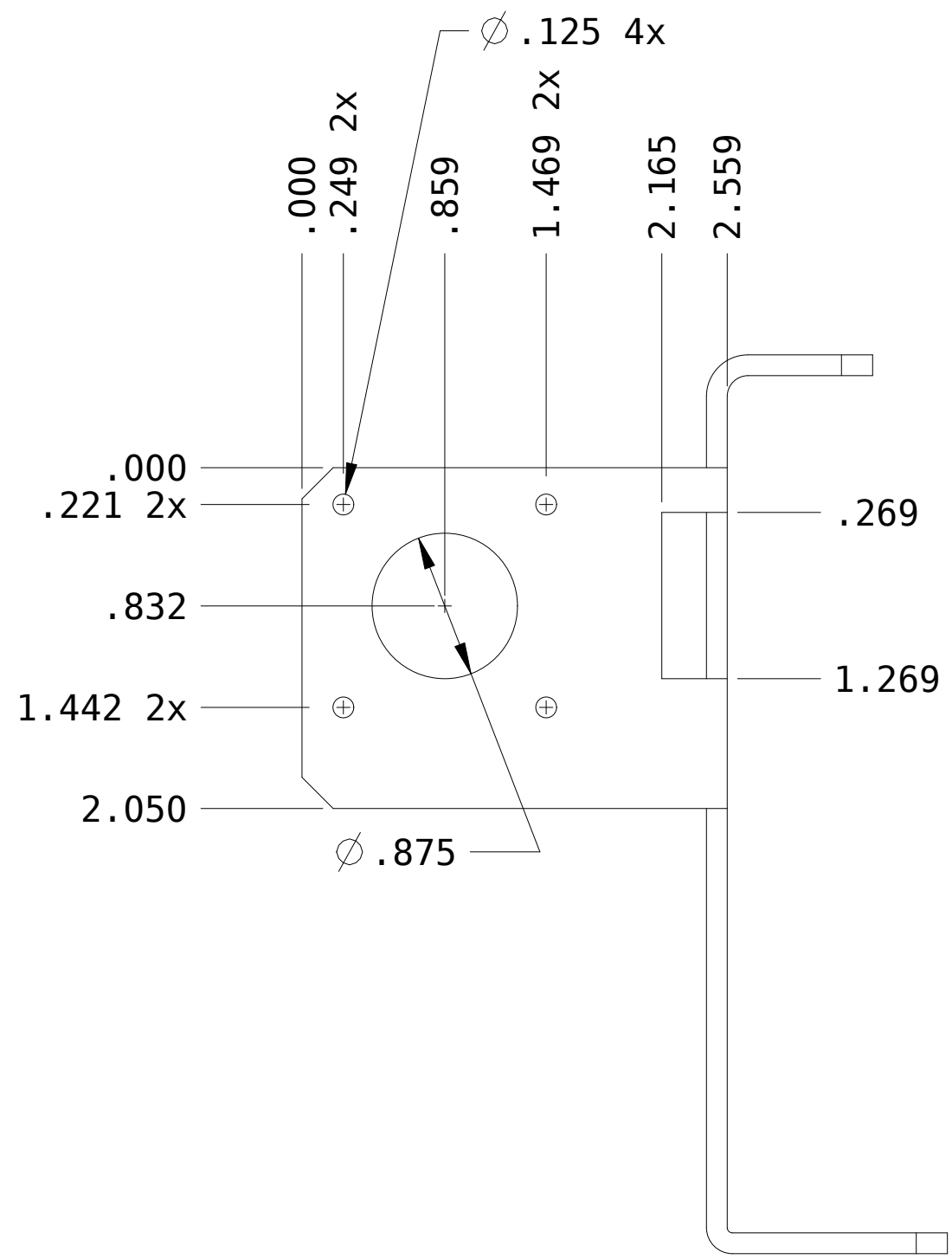

- Notes:
1. Material: .125 Thick 5052 Aluminum.
  2. Inside Bend radii to be sharp to .06 rad. max. Outer edges shall not show signs of fracture or crazing.
  3. Material grain direction at suppliers descretion.
  4. Surface Finish: Time Saved
  5. Plating: Clear Iridite (RoHS Compliant)



The work is licensed under a Creative Commons Attribute-Share Alike 3.0 License

DRAWN	BJD	12/16/10
CHECKER		
MECH. ENGR.		
ELEC. ENGR.		
PROJ. ENGR.		
CHIEF ENGR.		

Y Bearing Plate		SCALE

www.buildlog.net
C30001-014
SHEET 1 OF 1